

Team Manager Booklet



The team managers meeting will take place at the tennis venue next to the qualification field on 17 July, at 14:15

All team managers are requested to attend this meeting (maximum 2 representatives per country). Teams without a team manager are advised to send one of their athletes to the meeting.

Please read this document upon receipt and bring it with you to the team manager's meeting.

Version 1.0 – 11 July 2023

Welcome word from the LOC

As Chairman of the Organizing Committee of the World Archery Para Championships 2023. I would like to welcome you all to Pilsen, Czech Republic.

Organising committee feels that this Championships is a unique event for all teams due to next year Paralympic Games in Paris. We will do our best to serve you a hospitality of the City of Pilsen

Pilsen is a great historical city in Czech Republic called city of sports. We hope that the main benefit for all teams is that everything will be centralized and travelling times between hotels and venues are maximum 15 minutes.

On behalf of our organizing committee, I wish your team great results and a fantastic stay in Pilsen.

Roman Suda

Chairman
LOC





Contents

Welcome word from the LOC - 2 -

Introduction - 4 -

 1.1 Opening - 4 -

 1.2 Important dates for the outdoor season - 4 -

Contacts - 5 -

Technical aspects of the competition - 6 -

 3.1 Number of participants per category - 6 -

 3.2 Competition programme - 6 -

 3.3 Practice - 7 -

 3.4 Equipment inspection - 8 -

 3.5 Rounds - 8 -

 3.6 Classification - 9 -

 3.7 Paralympic Qualifying Tournament - 9 -

 3.8 Appeal procedure - 9 -

Results - 10 -

 4.1 Timing control system - 10 -

 4.2 Results system - 10 -

Reminder on Rules - 11 -

 5.1 Dress regulations - 11 -

 5.2 Rules update - 11 -

 5.3 Accreditation cards rules - 11 -

 5.4 limited access to the field - 12 -

Logistics - 13 -

 6.1 Transportation - 13 -

 6.2 Meals during the event - 13 -

 6.3 Internet Access and additional hotel charges - 13 -

 6.4 Medical related issues - 13 -

Protocol, ceremonies, clean sport - 14 -

 7.1 Medal ceremonies - 14 -

 7.2 Mixed zone and press conferences: - 14 -

 7.3 Clean sport - 14 -

Archery venues - 16 -

 Event venues - 16 -

 Qualifications and eliminations - 16 -

 Finals venue - 17 -

Other informations - 18 -

 Athlete representative elections - 18 -

 Research survey for athletes - Harassment and Abuse in Sport - 18 -

Doubles nomination form - 19 -

Mixed team nomination form - 20 -

Appeal Form - 21 -

Introduction

1.1 Opening

- Brought to order by the World Archery technical delegate (TD), Mr. D. Ohlmann
- Introduction of the panel, by World Archery TD, Mr. D. Ohlmann
- Roll call of all attending nations (TD)
- Welcome speech, by Organising Committee
- Jury of Appeal, by World Archery TD

1.2 Important dates for the outdoor season

Date	Event	Entry Deadline Type
26 July 2023	Hyundai Archery World Cup stage 4 – Paris – FRA	Final



Contacts

Organisation Management

Chairman LOC

Roman Suda

roman.suda@czecharchery.cz
+420 724 073 469

Hotel and Accommodation

Hana Majarova

hana.majarova@czecharchery.cz
+420 733 565 769

Transport Manager

Tomas Korbela

+420 604 121 193

Competition Manager

Katerina Koncalova

katerina.koncalova@czecharchery.cz
+420 606 754 818

Press Officer

Klara Grapova

kgrapova@seznam.cz
+420 722 537 147

World Archery Federation

Thomas AUBERT – head of events and marketing
Dominique OHLMANN – technical delegate
Matteo PISANI – head of technology
Chris WELLS – head of communications

+41 79 664 99 27
ohlmann.dominique@gmail.com

Tournament Judge Commission

Alison HAGAMAN - chairperson
Alexandre VECCHIO
Paco GIMENEZ
Lee MILLER
Ghazaleh RASOULI
Charmaine HO
Megan TIERNEY

Guillermina GARCIA – deputy chairperson
Ahmed KOURA
Taavo ALLIK
Ranjan BHOWMIK
Ringa BALTRUSAITE
Pecilius TAN

National Judges:

David VOSTREZ
Andrea FOLTYNOVA
Kristina REITMEIER
Katerina MRAZKOVA

Katerina KONCALOVA
Petr POLANSKY
Josef BROZ
Rolf VOLUNGHOLEN

Director of Shooting

Carsten KUHN

World Archery Clean Sport supervisor

Meriem HAMROUCHE

WA International Classifiers

Hervé TOGGWILER – Chief Classifier
Hannah THIESMANN

Ela MATZKIN
Marinda ROTHAMM

Jury of Appeal

To be announced during the meeting

Technical aspects of the competition

3.1 Number of participants per category

Updated 11 July 2023

Member Associations: 55

	Individual		Doubles		Mixed Teams	
Recurve Men Open	66	1/48	24	1/12	20	1/12
Recurve Women Open	35	1/24	10	1/8		
Compound Men Open	84	1/48	28	1/12	24	1/12
Compound Women Open	47	1/24	16	1/8		
Men W1	29	1/16	8	1/4	7	1/4
Women W1	12	1/8	4	1/2		
VI1	12	1/8				
VI2/3	10	1/8				

3.2 Competition programme

The current version of the schedule, at the moment of writing the team managers booklet is v1.0 (11 July 2023, 15:00 UTC).

Please frequently refer to World Archery website for latest updates of the schedule, as changes may occur during the week. There will be two competition fields, one for men and one for women all throughout qualification and elimination.



3.3 Practice

There will be only one practice session for all athletes. The target assignment will not be applied to the official practice session and targets will be set at 70m, 50m and 30m in the proportion of competing athletes at the moment of final deadline registration and after the classification session.

The fields for practice will be made available by the organisers, and will run according to the following schedule:

DATE	TIME	FIELD	GROUP (if any)
16th July 2023, Sunday	10:00 to 12:30	Field 1 (Main) & Field 2 (secondary)	By Country : AUS - CHN - FRA - HUN - INA IND - IRI - IRL - IRQ - ITA JPN - KOR - MEX - POL - USA
	14:00 to 17:30	Field 1 (Main) & Field 2 (secondary)	By Country : AND - AUT - AZE - BEL - BRA CAN - CHI - COL - CRC - CYP CZE - ESP - FIN - GBR - GEO GRE - GUA - HKG - ISL - KAZ LAT - LTU - MAS - MGL - NED PAK - ROU - RSA - SEN - SGP SLO - SRB - SRI - SUI - SVK THA - TPE - TUR - UKR - UZB
17th July 2023, Monday	08:30 to 10:00	Field 2 (secondary)	Priority to : CWO - RWO
	10:30 to 13:00	Field 2 (secondary)	Priority to : W1M - RMO
	14:00 to 18:00	Field 2 (secondary)	Free
18th July 2023, Tuesday	09:00 to 11:00	Field 2 (secondary)	Priority to : CWO - RWO
	11:00 to 13:00	Field 2 (secondary)	Free
	14:00 to 16:00	Field 2 (secondary)	Priority to : W1M - RMO
	16:00 to 18:00	Field 2 (secondary)	Free
19th July 2023, Wednesday	09:00 to 12:00	Field 2 (secondary)	Free
	14:00 to 18:00	Field 2 (secondary)	Free
20th July 2023, Thursday	09:00 to 11:00	Field 2 (secondary)	Free
	14:00 to 16:00	Field 2 (secondary)	Free
21st July 2023, Friday	14:00 to 18:00	Field 2 (secondary)	Free (some targets reserved for VI elimin.)
22nd July 2023, Saturday		Field 2 (secondary)	
	14:00 to 18:00	Field 2 (secondary)	Only : RMO – RWO – W1M - WIW
23rd July 2023, Sunday	09:00 to 12:00	Field 2 (secondary)	Only : RMO - RWO

The schedule for practice will be updated during the competition when needed.

We remind that the practice is allowed only for archers who are still involved in the competition.

Qualification round practice

- 3 ends of 4 minutes practice on the Field of Play for qualification to immediately follow once the field is reset.
- Non-competing athletes can use the practice field if they are still involved in the competition.
- Schedule will be displayed in the official event hotel lobbies.



3.4 Equipment inspection

The equipment inspection will be done during official practice, teams will be called by the Judges to proceed to the equipment inspection area to get their equipment revised.

All para archers must present to the judges their own classification card.

The equipment inspection will not be limited to only the official practice, judges can, at any time during the competition, require inspecting an athlete's bow.

World Archery will use electronic bow scales for equipment inspection.

Preamble to Chapter 11:

This article lays down the type of equipment athletes are permitted to use when shooting in World Archery competitions. It is the athlete's responsibility to use equipment which complies with the rules. Any athlete found to be using equipment contravening World Archery Rules may have his scores disqualified. Described below are the specific regulations that apply to each division followed by the regulations that apply to all divisions.

15.1.5 - Any athlete found to be using equipment contravening World Archery Rules may have his scores partly or fully cancelled (see 11. Chapter 11-Athletes Equipment).

- All teams are to wear their team uniform with their name and have their valid accreditation during official practice
- Spare equipment must also be brought for inspection.
- Team managers are to check the details of their athletes such as, name, date of birth is correct beforehand.
- Inform the Judge if details are not correct and the Judge will inform World Archery Results Team. Instructions to use the tablet scoring system will be carried out if requested.

Athlete (back) Numbers

Athlete numbers will be issued on the day of the qualification round (with the score cards) during practice.

Athlete numbers must be worn on the quiver or thigh, facing the waiting line while shooting, throughout the event including finals.

Assistants for W1, and spotters for VI must wear the same back number as the athlete they assist.

The Environment

Team managers, please instruct your team members to use the litter bins located on the competition, practice ranges and common areas at all times.

Water

There will be fresh still water by supplier Fontana company. All participants will be given unique bottles by the LOC to environmental support or they can use their own bottles and refill them.

Non-Smoking

This is a non-smoking event.

Smoking is forbidden inside public buildings and all competition and training areas. This also includes electronic cigarettes, refer to book 3, Art.12.8.

3.5 Rounds

Target faces will **NOT** be changed after practice arrows. During a session, they will be changed only if the judges require it. Please instruct your athletes to mark all arrow holes during practice and competition.

The sessions will start on time, when there are no practice arrows scheduled on the competition venue, the matches will start as soon as the field is ready. Athletes should be alert and prepared for their matches to start earlier than scheduled.



In case of a bye, athletes may be allowed to shoot on their own target, provided the competition schedule allows. If the competition schedule allows, no score will be recorded or displayed and athletes shooting their bye must respect the DOS timing and signals of the competition. Recurve athletes are permitted to shoot 3 sets of practice and compound athletes are permitted to shoot 5 ends of practice for their bye.

3.6 Classification

The schedule of classification is published with the documents in the online system: <https://www.worldarchery.sport/competition/24833/pilsen-2023-world-archery-para-championships>

Assessment will be done in English. It is the responsibility of the team to ensure that someone assist the archer if needed.

Physically impaired archers :

The classification will be hold In : Tennis venue next to the qualification field (equipment storage and catering is also situated here)

Visually impaired archers :

The classification will be hold In : Pilsen – ophthalmologist clinic

Transportation will be arranged for all athletes by LOC.

3.7 Paralympic Qualifying Tournament

The full process of qualification for the Paralympic games is published on the IPC website :

https://www.paralympic.org/sites/default/files/2023-06/2023_06_19%20Paris%20QR_v1.5.6.pdf

1st Step : Mixed teams – The 4 best ranked teams in each category will obtain 1 woman and 1 man quota for their NPC

2nd Step: Individuals, who didn't obtain a quota through the mixed team event must be ranked (if necessary) in the World Championship results. It will be done by the QT secondary tournament.

3.8 Appeal procedure

- An Appeal form is attached to this document.
- In case of an intent to appeal or an actual appeal, the times indicated on the Appeal form must be considered.
- Appeal forms should be given to the Chairman of the Tournament Judge Commission or to their deputy.
- A fee of 50 USD (or 50 EUR) must be paid to the Chairman of the Tournament Judge Commission, for the appeal to be valid.
- If the appeal is upheld by the Jury of Appeal, the fee will be returned. In the case of the appeal being rejected, the fee will not be returned.

Results

4.1 Timing control system

World Archery timing equipment will be used for timing and scoreboards on preliminary rounds and finals. During qualifications and elimination rounds, the clock will run until the end, without interruption of the Director of Shooting.

4.2 Results system

- Qualification Round - scoring will be completed by athletes. One athlete records, on the official paper based score sheet, the scores of all other athletes on that target. At the same time, another athlete, on that same target, will enter all the scores of the athletes on that target into the scoring tablet.
- Scorecards MUST be signed by both the athlete and the scorer, have all the totals mathematically correct with the 10s+Xs and X count fully completed. Any scorecards where the 10s+Xs and X count are not completed a "0" will be given for the total of 10s+Xs and X count for that athlete. Any score cards not signed or the score total is missing will result in disqualification.
- Elimination Round – scoring will be completed by athletes. One athlete/team records the arrow values of both athletes/teams on the paper score sheet. While at the same time, the other athlete/team inputs the arrow values into the scoring tablet. Both athletes/teams should verify that all scores are written and entered correctly before returning back to the shooting line.
- At the end of the match, the scorecard must be fully completed and signed by the athletes (or agent/judge in the case of finals) involved in the match.
- Scoring tablets will be used during the Qualification and Elimination Rounds, but not in the Finals. Mr. Matteo Pisani (World Archery head of technology) is responsible for the results of the event.
- **IMPORTANT NOTE: There will be internet access in the official hotels and the venues. Because of this we will not distribute any printed results and information.**

Reminder on Rules

5.1 Dress regulations

20.1.1 During the Olympic Games, World Championships, World Ranking Events and World Cup Events, athletes and team officials shall dress in sports clothing on the field of play.

- All members of one team by category shall be dressed in the same team uniform. The teams of one country may wear different design and colour uniforms. Team officials may wear a different style but should wear the same colours and should be easily identified as the official of their team;
- Athletes shall wear trousers, shorts, dresses, skirts or divided skirts of their choice; however, this legwear may not be shorter than the athlete's fingertips when the arms and fingers are extended at the athlete's side. They shall wear long or short sleeved shirts, blouses, or tops, however, the upper body clothing must be fixed over each shoulder covering the front and back of the body while still covering the midriff when the athlete is at full draw.
- No denim or jeans, regardless the colour, or camouflage clothes and equipment may be worn nor any oversize or baggy type pants or shorts;
- During the Team and Mixed Team match play competition the same colour and style shirt/blouse/top and the same colour pants/shorts/skirts shall be worn;
- Due to weather conditions, protective clothing such as sweaters, track suits, raingear, etc. may be worn following approval by the Technical Delegate of the event, or, in his absence, the Chairperson of the Tournament Judge Commission;
- Headwear is optional;
- During finals with TV coverage, undershirts, compression shirts or sleeves may be used on condition that they match the predominant colour of the team shirt or are white (might include design, names or markings but the predominant colour should be white).

5.2 Rules update

The current World Archery Constitution and Rules is to be applied for this event (version 2023-03-01)

For specific rules to apply for Para-archery events:

Refer to Rules Book N°3, Chapter 21: <https://www.worldarchery.sport/rulebook/article/82>

As a particular note (and not an exhaustive one):

- Changes to adaptive equipment : <https://www.worldarchery.sport/rulebook/article/4078>
- VI spotters - seated 1 metre behind archer

Equipment Failure:

12.2.3. No extra time shall be allowed for equipment failure or the treatment of medical problems, but the athlete concerned may leave the shooting line to resolve the issue and return to shoot any remaining arrow(s) if the time limit permits. In the Team Event other member(s) of the team may shoot in the meantime.

5.3 Accreditation cards rules

Rule Book 2 – 3.8 Accreditation

3.8.1.1. Proof of accreditation shall be carried at all times on the competition area and shall be shown on request of appropriate officials.

3.8.1.2. Only holders of appropriate accreditation shall be allowed onto the relevant parts of the competition area.

Accreditation card:



Athletes and team officials, registered in WAREOS, will be issued a World Archery accreditation and lanyard. Please ensure all details are correctly entered in WAREOS.

Only one accreditation will be issued, with a lanyard, for all the 2023 season. Athletes and team officials should bring their accreditation to all World Archery events such as, all World Championships, Hyundai Archery World Cup stages and the Hyundai Archery World Cup Final.

Accreditation will consist of, a photograph, full name, role, category/bow discipline, country of representation, individual World Archery ID code and access privileges.

All accreditations will need to be validated and activated on site at each of the separate World Archery events.

There is a QR code on all accreditations that will be scanned to enter and exit the competition areas. Only athletes scheduled to compete at certain stages of the event are permitted on the Field of Play, together with one coach/official.

Photographs

Will be taken on venue the day prior to official practice. For athlete who do not already have one.

For a valid photograph, persons are to smile and wear their official Member Association team uniform. No hats or sunglasses can be worn.

Photos are used for both event accreditation and website biographies.

Athletes and team official profile photographs expire after 24 months. Athletes and team officials whose photographs have expired will be contacted to schedule a time during the week to retake the picture, in order to avoid affluence and gathering at accreditation booth.

Any athlete or official that desires to update their photograph in the system can go to the accreditation area to do so during the competition week.

Lost/Damage/Replacement costs:

For those persons that unfortunately forget to bring, damage or lose their accreditation, can purchase another accreditation from World Archery accreditation area at the event for the cost of 30 CHF (EUR/USD or local currency will be accepted, at a rate to be displayed on site).

5.4 Limited access to the field

The access to the field during the competition sessions will be limited to competing archers and only 1 coach by archer.

In case the archer and his/her coach are not able to go by themselves to the target for scoring and pulling arrows, they must ask the Chair of Judges to allow someone else for this task. In thi case, the designated person must stay under the tent during the shooting (not in the coach zone behind the shooting line).

Logistics

6.1 Transportation

There will be shuttle buses operating between all three official hotels and both venues. Daily schedule is published in lanseo system.

The distance from Court Yard Marriot and Vienna house to the **qualification field** is less than 1,5 km nad there is also option to use accessible route.

The distance from Court Yard Marriot and Vienna house to the **final field** is less than 500 m nad there is also option to use accessible route.

6.2 Meals during the event

Breakfast and Dinner will be served at hotels buffet style.

Lunch will be served in catering tent next to the qualification and final field. There will be menu delivered in advance for the information. Soup, salad bar and three options of lunch main course will be daily.

- Breakfast: 6:00 - 9:00 hrs
- Lunch: 11:00 - 14:00 hrs
- Dinner: 18:00 - 21:00 hrs

The only exception is lunch 16th July which will be served buffet style in official hotels 11:00 – 14:00 hrs

We ask all team Mangers who have Athletes with dietary requirements to fill google form which LOC sent by email.

6.3 Internet Access and additional hotel charges

Internet access will be free of charge in hotels.

All other expenses including laundry and minibar, etc will be covered by the participants themselves.

Any damages will be charged to the participants national team.

Parking at hotels Marriott Courtyard and Vienna house is charged.

6.4 Medical related issues

First Aid services will be available from 16th to the 23rd of July at the archery venues. Operated by First Aid company.

In cases of emergencies in official hotels, please inform hotel contact person and ask LOC for assistance.

The closest hospital for emergencies is:

Medical emergency contact and location

Fakultní nemocnice Plzeň / Pilsen General hospital

Address: Alej Svobody 80, 304 60 Plzeň

Tel: +420 377 103 111

Protocol, ceremonies, clean sport

7.1 Medal ceremonies

All athletes involved in the ceremonies are requested to go to the gathering point by the athletes' entrance to the main FoP, equipment can be stored in the staging area until the end of the corresponding victory ceremony.

Medal ceremonies will be conducted immediately after the interview of gold medal winner of each category during the days of the finals (please check the competition schedule).

Athletes are requested to proceed straight to the mixed zone or the ceremony area.

7.2 Mixed zone and press conferences:

Interviews will take place at the Mixed Zone and athletes will be requested to pass through the mixed zone to speak with the media.

7.3 Clean sport

Anti-doping

Anti-Doping control will follow World Archery rules.

Athletes should bring their passports and/or accreditation cards to the anti-doping control station if selected for a test.

Alcohol test

Athletes and officials should also be available for random alcohol testing during the competition, following World Archery rules.

Alcohol testing can be performed at any moment on anyone that is present on accredited areas of the field of play.

2.3.4 Alcohol Test

Alcohol is a banned substance in archery. No person on the field of play shall consume alcohol or be under the influence of alcohol as prohibited in 2.3.4. Alcohol Test. Athletes selected for Anti-Doping Sample collection shall also be tested for alcohol. Tests may be carried out at any time during the Competition at any International Event at the discretion of the person designated by World Archery to conduct the Alcohol Test, or by the Organising Committee if World Archery has not designated any such person.

2.3.4.1 Procedure for alcohol tests

The alcohol test is performed by the testing of exhaled air. If the test of exhaled air exceeds the doping violation threshold of 0.1 per mille, a second test of exhaled air will be performed 10 minutes later using a different breathalyser. If the second test of exhaled air still exceeds the threshold, this will result in a positive alcohol test.

15.5 Consequences of a Positive Alcohol Test

15.5.1 If an alcohol test performed on a person subject to 2.3.4. Alcohol Test in Book 1 results in positive before the end of an Event, such person shall be withdrawn from the Event and the case will be forwarded to the Board of Justice and Ethics for further sanctions.

15.5.2 Consequences are:



- *Disqualification of the Event;*
- *1 year of ineligibility for the first offense;*
- *4 years of ineligibility for the second offense;*
- *Life ban for the third offense.*

Archery venues

Event venues

Qualifications and eliminations

For a video of accessible route from hotels Vienna House and Courtyard Marriott please follow this link:
<https://youtu.be/vuUqL3-AUYY>

The Viktoria Pilsen soccer training fields Lucni street:

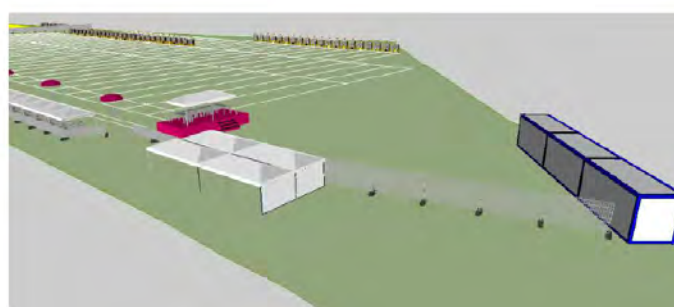
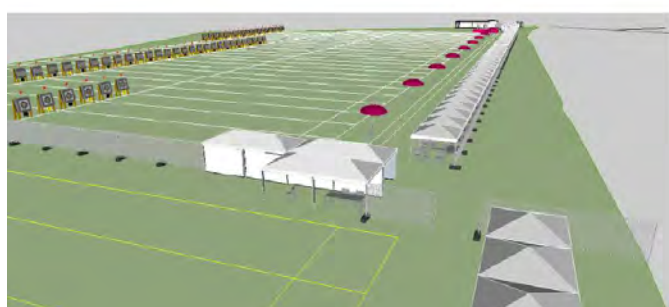

IT IS IMPORTANT TO NOTE THE FOLLOWING ACCESS RESTRICTION

VIP Guest passes are available through the LOC. Without Athlete, Officials or Guest Pass there is no access to the Qualification or practice area.

Spectators will only be able to see the Finals.

Finals venue

Pilsen main Republic square, next to St. Bartolomew Cathedral

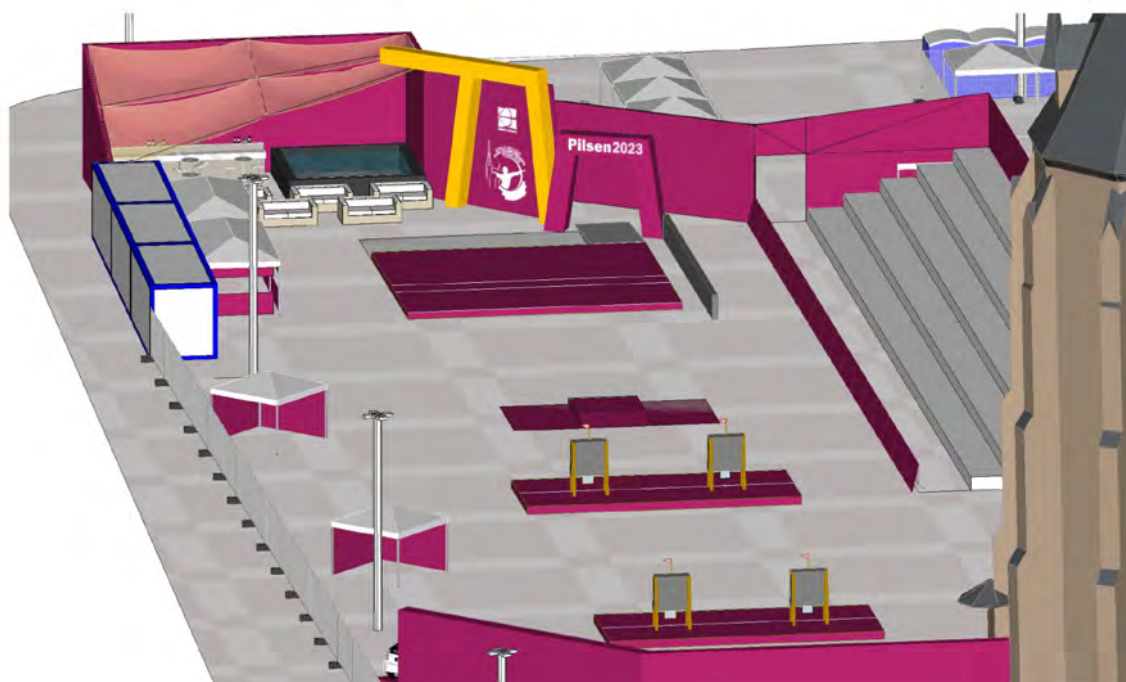

Other informations

Athlete representative elections

There are elections for athlete representative for Para Archery Committee for next 4 years. All participating athletes are encouraged to express their vote on the first days of competition. Voting will be open close to the lunch area until 19 July 13:00

There is one candidate – Eric Bennett (USA) - and majority of votes cast will need to be achieved to be elected.

Research survey for athletes - Harassment and Abuse in Sport

The Association of Summer Olympic International Federations (ASOIF) has initiated a pilot research study into the prevalence of harassment and abuse in elite sport. Six international federations are participating in this study of which one is World Archery. Data collection - a survey for athletes - will take place at during the first three days until 19 July. The contact on site will be Siret Luik who will be present close to the lunch area.

Team managers are asked to share this communication with their athletes, coaches and entourage participating at these events. The survey is only for athletes, but if team managers or coaches would like to know the questions and content of the survey, please contact Siret Luik by email: safeguarding@archery.sport

The success of this project is strongly dependent on the communication within the teams. Thank you for your help in encouraging athlete to take the survey.

Project Background and Objectives:

Everyday athletes train and compete at the highest level. Recently, more attention is being given to the physical and mental wellbeing of elite athletes, but there is limited information on the negative experiences that affect them. Therefore, researchers from two universities (Canada and Belgium) in collaboration with World Archery are conducting this study to fill this gap in knowledge. The benefit is to gain insight into factors affecting athlete safety that will aid in the development of prevention strategies that protect athletes and enable them to perform at their peak.

Questionnaire Overview:

Athletes aged 18 years and above will be asked to answer a short, anonymized online survey (15-20 minutes) about their physical and mental health as well as their experiences in sport. All information collected in this anonymized survey will be kept confidential and results will only be shared in an aggregated manner. Athlete participation is voluntary following informed consent. IF officials will not know who did or did not participate in this survey, nor will the IF have access to the data. Support will be available onsite should an athlete have questions or concerns about the questionnaire.

Timeline:

This project is already in progress with six international sport federations implementing the survey at various competitions. Data collection will take place at two World Archery events. Anonymized results will be provided to World Archery and an official overall report outlining aggregated data of all six sports will be available in 2024.

The Research Team:

The research team consists of researchers from McMaster University in Canada (Dr. Margo Mountjoy) and Thomas More University in Belgium (Dr Tine Vertommen). The project has received independent Ethical Approval from the Hamilton Integrated Research Ethics Board.

Doubles nomination form

Country: _____

Recurve men Open Doubles:

1.

2.

athlete NOT in the team:

Recurve women Open Doubles:

1.

2.

athlete NOT in the team:

Compound men Open Doubles:

1.

2.

athlete NOT in the team:

Compound women Open Doubles:

1.

2.

athlete NOT in the team:

Men W1 Doubles:

1.

2.

athlete NOT in the team:

Women W1 Doubles:

1.

2.

athlete NOT in the team:

Name and signature of Team Manager:

.....

The results of the 3 highest scoring members of the team, per discipline and gender will automatically be used for the team events. If Team Managers wish to use other athletes of the team, please use this form to name the athletes that will be competing in the team event.

Forms to be given to the World Archery head of technology or Chairman of the Judges Commission at least 15 minutes before the start of the team competition.



Mixed team nomination form

Country:

Recurve Open Mixed team:

1.

2.

Compound Open Mixed team:

1.

2.

W1 Mixed team

1.

2.

Name and signature of Team Manager:

.....

The results of the highest scoring male and female members of the team will automatically be used for the mixed team event. If Team Managers wish to use other athletes of the team, please use this form to name the athletes that will be competing in the mixed team event.

Forms to be given to the World Archery head of technology or Chairman of the Judges Commission at least 15 minutes before the start of the mixed team competition.



Appeal Form

This is an intention of Appeal

This is an appeal form

(please tick appropriate box)

Appeal Fee	
•	50 USD
•	50 CHF
•	50 EUR

- Team Manager of the following country: _____
- Name of the Team Manager: _____
- Team (please name country) : _____
- Individual person (name) : _____
- Other (please specify) : _____

This appeal is against: _____

Description of Appeal or Protest:

I believe this action is against the following rules (state article if known): _____

Signature: _____ Name in printing: _____

Article 3.13.3.1:

An intention to appeal when it might affect the progression of an athlete from one stage of the competition to the next, shall be expressed in writing and lodged with the chairperson of the Tournament Judge Commission within five minutes of the end of the relevant round or match, whichever applies. During the Finals of match play rounds, the notice of intent to file an appeal shall be given within five minutes of the end of the match, or prior to the start of the next match, whichever is first.

Article 3.13.8:

Jury decisions shall be minuted and reported to the appellant, the chairperson of the Tournament Judge Commission and the organisers before the beginning of the next stage of the competition or before the awarding of prizes.

Article 3.13.4:

Amount paid is reviewed and determined by the World Archery Executive Board on an annual basis.

Received on: ____/____/____ Time: _____

by Chairperson of the Tournament Judge Commission

Signature: _____ Name in printing: _____



Athlete: _____ Rank
 Country: _____ **1**
 Category: **Recurve** Target 001

	<input checked="" type="checkbox"/> Winner			Gold				Tot.	
	1	2	3	Set Total	Running Total	Set Points			
1	10	9	10	29	29	2	1	0	2
2	10	9	9	28	57	2	1	0	2
3	10	10	9	29	86	2	1	0	4
4	9	10	10	29	115	2	1	0	6
5						2	1	0	
Total									6

s.o. Closest to the center

Archer Signature
 Scorer Signature

Judge Annotations

Athlete: _____ Rank
 Country: _____ **15**
 Category: **Recurve** Target 002

	<input type="checkbox"/> Winner			Gold				Tot.	
	1	2	3	Set Total	Running Total	Set Points			
1	10	9	9	28	28	2	1	0	0
2	10	10	9	29	57	2	1	0	2
3	9	10	9	28	85	2	1	0	2
4	9	9	10	28	113	2	1	0	2
5						2	1	0	
Total									2

s.o. Closest to the center

Archer Signature
 Scorer Signature

Judge Annotations

1/1



Athlete: _____ Rank
 Country: _____ **25**
 Category: **Compound** Target 001

	<input type="checkbox"/> Winner			Gold				10+X	X		
	1	2	3	Sum	Running Total	Set Points					
1	10	X	9	29	29	2	1				
2	X	9	9	28	57	1	1				
3	10	9	X	29	86	2	1				
4	10	10	10	30	116	3	0				
5	10	9	8	27	143	1	0				
Total									143	9	3

s.o. 10 Closest to the center

Archer Signature
 Scorer Signature

Judge Annotations

Athlete: _____ Rank
 Country: _____ **2**
 Category: **Compound** Target 002

	<input checked="" type="checkbox"/> Winner			Gold				10+X	X		
	1	2	3	Sum	Running Total	Set Points					
1	9	9	10	28	28	1	0				
2	10	X	X	30	58	3	2				
3	X	9	8	27	85	1	1				
4	9	9	X	28	113	1	1				
5	X	10	X	30	143	3	2				
Total									143	9	6

s.o. 10* Closest to the center

Archer Signature
 Scorer Signature

Judge Annotations

1/1





Country: _____ Rank **4**

Category: **Recurve** Team Target 001

Country: _____ Rank **3**

Category: **Recurve** Team Target 002

	Winner						Gold			
	1	2	3	4	5	6	Set Total	Tot.	Set Points	Tot.
1	10	9	8	8	9	10	54	54	2 1 0	1
2	8	10	9	8	9	10	54	108	2 1 0	1
3	10	10	8	10	9	10	57	165	2 1 0	3
4	9	9	10	10	10	9	57	222	2 1 0	5

	Winner						Gold			
	1	2	3	4	5	6	Set Total	Tot.	Set Points	Tot.
1	10	9	9	10	7	9	54	54	2 1 0	1
2	8	9	9	10	10	9	55	109	2 1 0	3
3	9	9	8	10	9	10	55	164	2 1 0	3
4	9	9	10	9	9	10	56	220	2 1 0	3

S.O. _____ Total **5**

Closest to the center

Archer *Signature*

Scorer *Signature*

Judge Annotations _____

S.O. _____ Total **3**

Closest to the center

Archer *Signature*

Scorer *Signature*

Judge Annotations _____

1/1



Country: _____ Rank **1**

Category: **Compound** Team Target 001

Country: _____ Rank **2**

Category: **Compound** Team Target 002

	Winner						Gold			
	1	2	3	4	5	6	Sum	Tot.	10+X	X
1	10	9	X	X	X	X	59	59	5	4
2	9	9	10	10	10	9	57	116	3	0
3	X	X	10	X	X	9	59	175	5	4
4	10	9	9	10	10	10	58	233	4	0

	Winner						Gold			
	1	2	3	4	5	6	Sum	Tot.	10+X	X
1	10	10	9	10	9	10	58	58	4	0
2	X	10	10	X	10	9	59	117	5	2
3	X	10	9	X	9	10	58	175	4	2
4	X	10	9	10	10	9	58	233	4	1

S.O. _____ Total **233** 17 8

Closest to the center

Archer *Signature*

Scorer *Signature*

Judge Annotations _____

S.O. _____ Total **233** 17 5

Closest to the center

Archer *Signature*

Scorer *Signature*

Judge Annotations _____

1/1





Country: _____ Rank **4**
 Category: **Recurve Mixed Team** Target 001

	Winner				Bronze			
	1	2	3	4	Set Total	Tot.	Set Points	Tot.
1	8	10	10	8	36	36	2 1 0	1
2	10	8	10	10	38	74	2 1 0	3
3	9	10	9	9	37	111	2 1 0	4
4	9	10	9	9	37	148	2 1 0	4

S.O. Total **4**
 Closest to the center

Archer *Signature*
 Scorer *Signature*
 Judge Annotations

Country: _____ Rank **11**
 Category: **Recurve Mixed Team** Target 002

	Winner				Bronze			
	1	2	3	4	Set Total	Tot.	Set Points	Tot.
1	8	10	8	10	36	36	2 1 0	1
2	8	10	9	8	35	71	2 1 0	1
3	10	8	10	9	37	108	2 1 0	2
4	9	10	10	9	38	146	2 1 0	4

S.O. Total **5**
 Closest to the center

Archer *Signature*
 Scorer *Signature*
 Judge Annotations

1/1



Country: _____ Rank **1**
 Category: **Compound Mixed Team** Target 015

	Winner				1/8			
	1	2	3	4	Sum	Tot.	10+X	X
1	10	10	9	9	38	38	2	0
2	10	10	10	9	39	77	3	0
3	X	10	10	9	39	116	3	1
4	X	10	10	9	39	155	3	1

S.O. Total **155** **11** **2**
 Closest to the center

Archer *Signature*
 Scorer *Signature*
 Judge Annotations

Country: _____ Rank **16**
 Category: **Compound Mixed Team** Target 016

	Winner				1/8			
	1	2	3	4	Sum	Tot.	10+X	X
1	10	10	9	9	38	38	2	0
2	X	10	10	9	39	77	3	1
3	X	10	9	9	38	115	2	1
4	X	10	9	9	38	153	2	1

S.O. Total **153** **9** **3**
 Closest to the center

Archer *Signature*
 Scorer *Signature*
 Judge Annotations

1/1



Policies and Procedures

Officials and Team Management

Introduction

Since we have more and more teams coming with more and more athlete support personnel, it is time that clear provisions are made on the type of official and what their access is to the field of play.

Definition of team officials:

- Coach (a person that is involved in assisting the athlete from the waiting area and has a qualification in doing so recognised by his national federation)
- Team Manager (the person in charge of the management of the team including taking responsibility for the behaviour of all athletes and other officials. This person is not necessarily a coach)
- Medical (a medical doctor who has a medical certification and who can only act on people of his own team if he is so authorised to do so)
- Other athlete support staff (Physiotherapist, Sport Psychologist, Nutritionist, Biomechanical researcher, ...)
- Other National Federation officials (President, Secretary General, Technical Director, translators...)
- Other World Archery Officials and staff
- Other (not defined and therefore should be avoided) Definition of

Field of Play and controlled area:

- The definition for the purpose of this document is the area where the archers are shooting their competition, and which is controlled by an accreditation check. This includes the waiting area and the rest area.

For instance, there is a clear difference in terms of the access of a coach that is actively coaching an athlete and a physiotherapist or sport psychologist.

Teams must manage themselves and at no moment will World Archery advantage teams over others. Especially small teams with as good as no officials should not be disadvantaged on the actual field of play.

When we define field of play, we also need to be clear which area we consider. For instance, it is not the same on what is the waiting area where coaches would typically spot the arrows and the tent area where other necessary officials could have access when required (for instance team manager or medical staff in case of emergency).

In terms of the actual management of the team numbers, this is first of all the role of the team itself and their team manager. In case there are issues he will be the first responsible to resolve them or also suffer the consequences of misbehaviour of their athletes or officials.

On the active part of the field of play the current rule works which is maximum 1 coach per athlete

In consultation with the medical committee, it is quite clear that unless in case of medical emergency, there is absolutely NO NEED for any medical staff to have access to the field of play. Depending on the configuration you can argue that they have access to the rest area but in future specific areas should be made available where medical staff and other athlete support staff (such as physiotherapists, chiropractors, ...) can assist the athletes. These areas should provide a minimum privacy and should not just be in an open tent or other open area but close to the access gates of the field of play.

Access for the team manager. A team manager has access to the field of play as long as any athlete of his team is competing or has finished competing in the 15 minutes preceding the time, so he can take care of any official business for his team such as:

- Making sure that his team members are only on the field of play when necessary
- Give information to his team
- File an intention of appeal or appeal if necessary
- Communication with the judges, LOC or World Archery
- Get emergency assistance for his team members

ONLY Team officials that are in proper uniform (meaning clearly identifiable as belonging to the athletes shooting at that time and in the same colour schemes) can be in the controlled area. This includes the National Federation Presidents, Secretary General, Technical Director or anyone else.

Use of upgrade cards

Teams can purchase upgrade cards which are non-transmissible and for one event only. These upgrade cards do not provide additional number of officials on the field. In case of misuse they will be invalidated, and further action could be taken.

Access to VIP areas for Team officials

In principle there is no access for team officials to VIP areas unless they have a specific VIP accreditation. The following people have automatic access to VIP zones:

- World Archery Executive Board Members & Senior World Archery staff
- LOC Board & Senior Staff
- World Archery Permanent Committee members (on condition that they are not accredited as team official for the event)
- A maximum of two representatives of future organisers of World Archery events (World Cup stages, World Cup Final, World Championships)
- The President and Secretary General of the host nation if they are not part of the LOC
- Sponsor guests
- Guests of World Archery and the LOC based on an agreed list by the LOC and World Archery
- Jury members if no other place is available for them to be close to the field of play

The LOC might offer additional access for the VIP area at cost for national federation officials. The cost will be communicated upon arrival at the event.

Consequences of not respecting access to controlled areas:

Any accredited person that is not respecting the access to the controlled areas will be verbally warned and asked to leave the zone. Failure to do so might result in loss of accreditation for the day, the event or in suspension and fines for the person concerned and/or the team concerned. The decision for the removal of the accreditation lies with the World Archery Secretary General or in his absence the Event Director. For consequences beyond the event, the matter will be sent to the Board of Justice & Ethics.